

Pantalla



Código para escanear vídeos



www.kaercher.com/fc7

KÄRCHER

FC 7 FREGONA ELÉCTRICA GUÍA DE INICIO RÁPIDA

Montaje



Pasos antes de usarlo

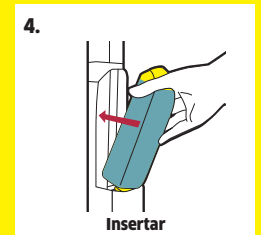
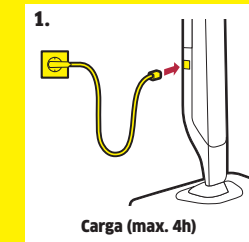



Cambio modo de limpieza

Nivel 1

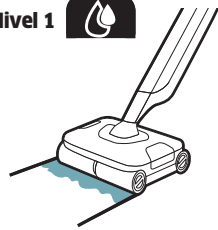

Para suelos de madera

Nivel 2



Para suelos de piedra



Activar función boost

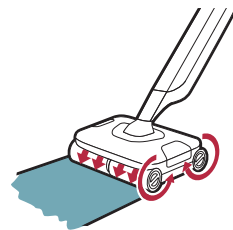

Señal depósito agua limpia vacío

1.

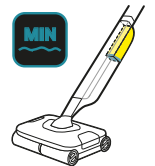

2.

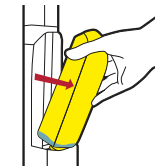

3.



4.

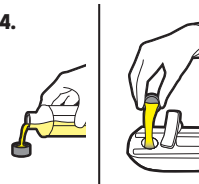

5.

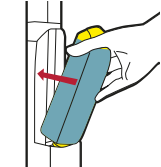

Señal depósito agua sucia lleno

1.



2.

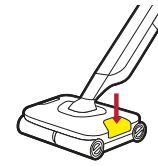

3.

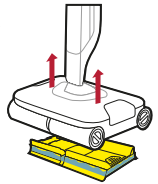

4.



5.

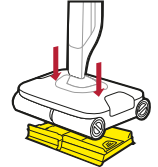

Limpieza y almacenaje

Paso 1: Limpia el dispositivo

1.

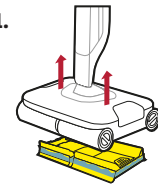

2.

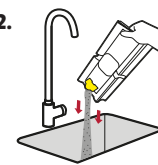

3.



4.

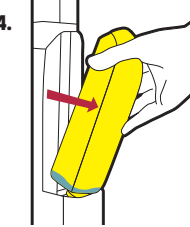

5.

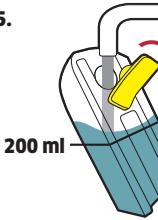

6.

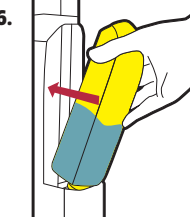

7.

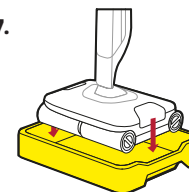

8.



9.

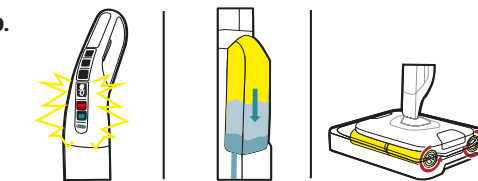

Por favor espere unos 2 min.

Paso 2: Almacenaje del dispositivo

10.

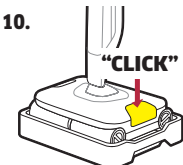

11.

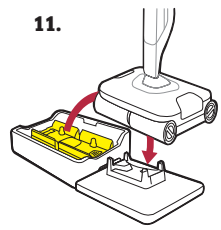

12.

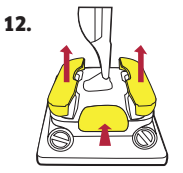

13.

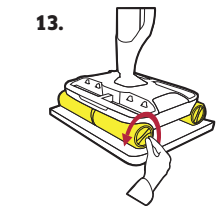

14.

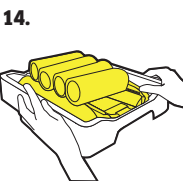

15.

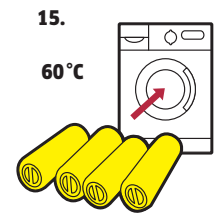

16.



17.

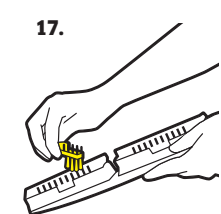

18.

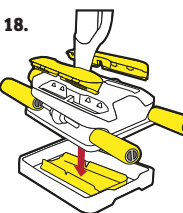

19.

